

## ISO and Small Cartridges

Rigibore ISO (lay in) cartridges are available in a wide range of styles and sizes for all applications, including:

06CAx7, 06CA, 08CA, 10CA, 12CA (16CA available to order)

Standard stocked ISO and small cartridges

### Great choice

Complete range held in stock

### Outstanding value

Phone today or send an enquiry through our website for best prices and delivery times

### Minimum bore

15.6mm/0.614"

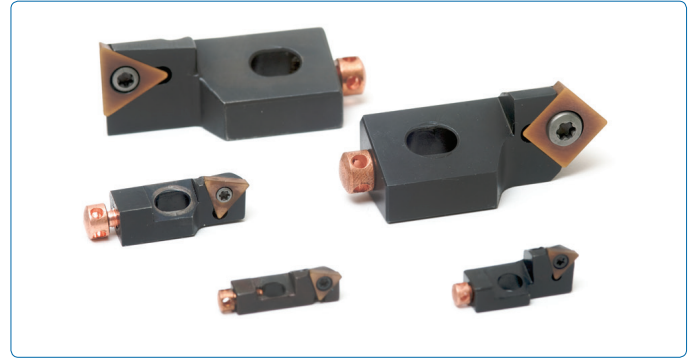
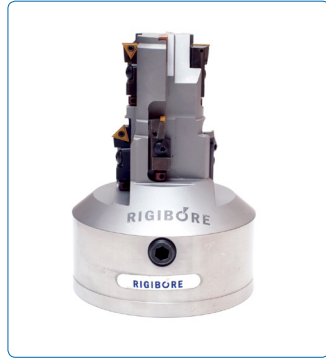

● Tools for building-in

● Full range available

## ISO and Small Cartridges Technical Specification

Right hand – Shown  
Left hand – Mirror image

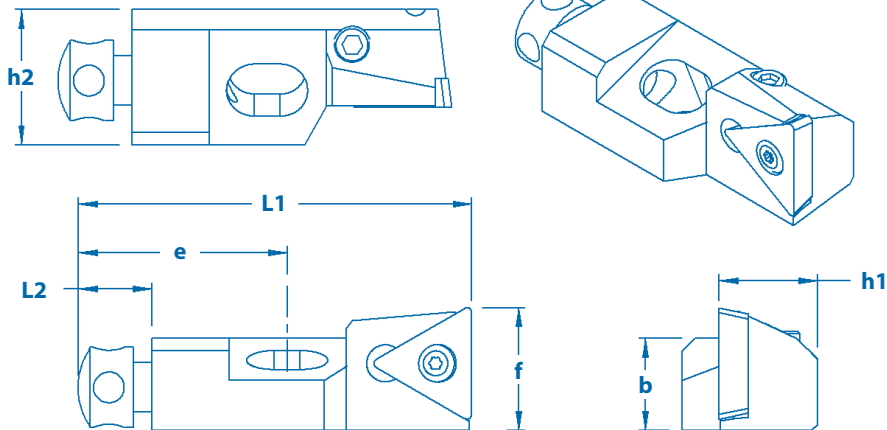

Style/Size	Axial Adjustment	
	mm	inch
06CAx7	± 0.5	± 0.0197
06CA	± 0.5	± 0.0197
08CA	± 1.0	± 0.0394
10CA	± 1.0	± 0.0394
12CA	± 1.0	± 0.0394
16CA	± 1.5	± 0.0591

## ISO and Small Cartridges Technical Specification

	Part Number	L1		L2		b		h1		h2		f		e		Insert	Datum Rad	
		mm	inch	mm	inch	mm	inch	mm	inch	mm	inch	mm	inch	mm	inch		mm	inch
	STFCR/L 06CA-06X7	24.5	0.965	4.5	0.177	4.5	0.177	6.0	0.236	6.0	0.236	7.0	0.276	12.0	0.472	TC06..T1..	0.2	0.008
	STFCR/L 06CA-06	25.0	0.984	4.5	0.177	5.0	0.197	6.0	0.236	8.0	0.315	8.0	0.315	12.0	0.472	TC06..T1..	0.4	0.016
	STFPR/L 06CA-06															TP06..T1..		
	STFCR/L 08CA-09	32.0	1.260	6.0	0.236	7.5	0.295	8.0	0.315	11.0	0.433	10.0	0.394	17.0	0.669	TC..0902..	0.4	0.016
	STFPR/L 08CA-09															TP..0902..		
	STFCR/L 10CA-11	50.0	1.969	8.0	0.315	11.0	0.433	10.0	0.394	15.0	0.591	14.0	0.551	20.0	0.787	TC..1102..	0.4	0.016
	STFPR/L 10CA-11															TP..1102..		
	STFCR/L 12CA-16	55.0	2.165	8.0	0.315	15.0	0.591	12.0	0.472	20.0	0.787	20.0	0.787	20.0	0.787	TC..16T3..	0.8	0.031
	STFCR/L 12CA-16															TP..16T3..		
STFCR/L 16CA-16	63.0	2.480	8.0	0.315	20.0	0.787	16.0	0.630	20.0	0.787	25.0	0.984	25.0	0.984	TC..16T3..	0.8	0.031	
STFPR/L 16CA-16															TP..16T3..			
	STTCR/L 06CA-06X7	24.5	0.965	4.5	0.177	4.5	0.177	6.0	0.236	6.0	0.236	3.7	0.146	12.0	0.472	TC..16T3..	0.2	0.008
	STTCR/L 06CA-06	25.0	0.984	4.5	0.177	5.0	0.197	6.0	0.236	8.0	0.315	5.5	0.217	12.0	0.472	TC..06T1..	0.4	0.016
	STTPR/L 06CA-06															TP..06T1..		
	STTCR/L 08CA-09	32.0	1.260	6.0	0.236	7.5	0.295	8.0	0.315	11.0	0.433	6.0	0.236	17.0	0.669	TC..0902..	0.4	0.016
	STTPR/L 08CA-09															TP..0902..		
	STTCR/L 10CA-11	50.0	1.969	8.0	0.315	11.0	0.433	10.0	0.394	15.0	0.591	9.0	0.354	20.0	0.787	TC..1102..	0.4	0.016
	STTPR/L 10CA-11															TP..1102..		
	STTCR/L 12CA-16	55.0	2.165	8.0	0.315	15.0	0.591	12.0	0.472	20.0	0.787	13.0	0.512	20.0	0.787	TC..16T3..	0.8	0.031
	STTPR/L 12CA-16															TP..16T3..		
	STSCR/L 06CA-06X7	24.5	0.965	4.5	0.177	4.5	0.177	6.0	0.236	6.0	0.236	7.0	0.276	12.0	0.472	TC..06T1..	0.2	0.008
	STSCR/L 06CA-06	21.0	0.827	4.5	0.177	5.0	0.197	6.0	0.236	8.0	0.315	8.0	0.315	12.0	0.472	TC..06T1..	0.4	0.016
	STSPR/L 06CA-06															TP..06T1..		
	STSCR/L 08CA-09	28.0	1.102	6.0	0.236	7.5	0.295	8.0	0.315	11.0	0.433	10.0	0.394	17.0	0.669	TC..0902..	0.4	0.016
	STSPR/L 08CA-09															TP..0902..		
	STSCR/L 10CA-11	44.0	1.732	8.0	0.315	11.0	0.433	10.0	0.394	15.0	0.591	14.0	0.551	20.0	0.787	TC..1102..	0.4	0.016
	STSPR/L 10CA-11															TP..1102..		
	STSCR/L 12CA-16	47.0	1.850	8.0	0.315	15.0	0.591	12.0	0.472	20.0	0.787	20.0	0.787	25.0	0.984	TC..16T3..	0.8	0.031
	STSPR/L 12CA-16															TP..16T3..		
	STRCR/L 08CA-09	32.0	1.260	6.0	0.236	7.5	0.295	8.0	0.315	11.0	0.433	7.8	0.307	17.0	0.669	TC..0902..	0.4	0.016
	STRPR/L 08CA-09															TP..0602..		
	STUCR/L 08CA-09	32.0	1.260	6.0	0.236	7.5	0.295	8.0	0.315	11.0	0.433	10.0	0.394	17.0	0.669	TC..0902..	0.4	0.016
	STKCR/L 06CA-06X7	24.5	0.965	4.5	0.177	4.5	0.177	6.0	0.236	6.0	0.236	7.0	0.276	12.0	0.472	TC..06T1..	0.2	0.008
	STKCR/L 06CA-06	25.0	0.984	4.5	0.177	5.0	0.197	6.0	0.236	8.0	0.315	8.0	0.315	12.0	0.472	TC..06T1..	0.4	0.016
	STKPR/L 06CA-06															TP..06T1..		
	STKCR/L 08CA-09	32.0	1.260	6.0	0.236	7.5	0.295	8.0	0.315	11.0	0.433	10.0	0.394	17.0	0.669	TC..0902..	0.4	0.016
	STKPR/L 08CA-09															TP..0902..		

Continued...

Continued...

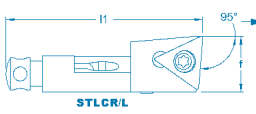
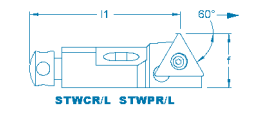
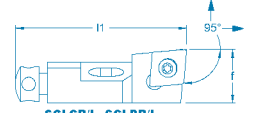
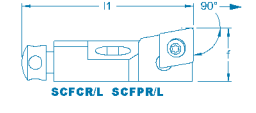
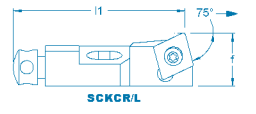
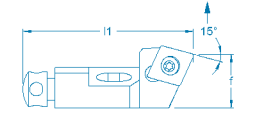
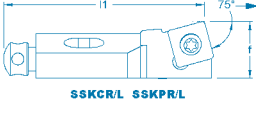
	Part Number	L1		L2		b		h1		h2		f		e		Insert	Datum Rad	
		mm	inch	mm	inch	mm	inch	mm	inch	mm	inch	mm	inch	mm	inch		mm	inch
 <p>STLCR/L</p>	STLCR/L 06CA-06X7	24.5	0.965	4.5	0.177	4.5	0.177	6.0	0.236	6.0	0.236	7.0	0.276	12.0	0.472	TC06..T1..	0.2	0.008
 <p>STWCR/L STWPR/L</p>	STWCR/L 06CA-06X7	21.0	0.827	4.5	0.177	4.5	0.177	6.0	0.236	6.0	0.236	7.0	0.276	12.0	0.472	TC06..T1..	0.2	0.008
	STWCR/L 06CA-06	21.0	0.827	4.5	0.177	5.0	0.197	6.0	0.236	8.0	0.315	8.0	0.315	12.0	0.472	TC06..T1..	0.4	0.016
	STWPR/L 06CA-06															TP06..T1..		
	STWCR/L 08CA-09	28.0	1.102	6.0	0.236	7.5	0.295	8.0	0.315	11.0	0.433	10.0	0.394	17.0	0.669	TC..0902..	0.4	0.016
STWPR/L 08CA-09	TP..0902..																	
 <p>SCLCR/L SCLPR/L</p>	SCLCR/L 08CA-06	32.0	1.260	6.0	0.236	7.5	0.295	8.0	0.315	11.0	0.433	10.0	0.394	17.0	0.669	CC..0602..	0.4	0.016
	SCLPR/L 08CA-06															CP..0602..		
 <p>SCFCR/L SCFPR/L</p>	SCFCR/L 08CA-06	32.0	1.260	6.0	0.236	7.5	0.295	8.0	0.315	11.0	0.433	10.0	0.394	17.0	0.669	CC..0602..	0.4	0.016
	SCFPR/L 08CA-06															CP..0602..		
	SCFCR/L 10CA-09	50.0	1.969	8.0	0.315	11.0	0.433	10.0	0.394	15.0	0.591	14.0	0.551	20.0	0.787	CC..09T3..	0.8	0.031
	SCFPR/L 10CA-09															CP..09T3..		
 <p>SCKCR/L</p>	SCKCR/L 08CA-06	32.0	1.260	6.0	0.236	7.5	0.295	8.0	0.315	11.0	0.433	10.0	0.394	17.0	0.669	CC..0602..	0.4	0.016
 <p>SCRCR/L</p>	SCRCR/L 08CA-06	32.0	1.260	6.0	0.236	7.5	0.295	8.0	0.315	11.0	0.433	10.0	0.394	17.0	0.669	CC..0602..	0.4	0.016
 <p>SSKCR/L SSKPR/L</p>	SSKCR/L 10CA-09	50.0	1.969	8.0	0.315	11.0	0.433	10.0	0.394	15.0	0.591	14.0	0.551	20.0	0.787	SC..09T3..	0.8	0.031
	SSKPR/L 10CA-09															SP..09T3..		
	SSKCR/L 12CA-12	55.0	2.165	8.0	0.315	15.0	0.591	12.0	0.472	20.0	0.787	20.0	0.787	20.0	0.787	SC..1204..	0.8	0.031
	SSKPR/L 12CA-12															SP..1204..		

## ISO and Small Cartridges Mounting Dimensions

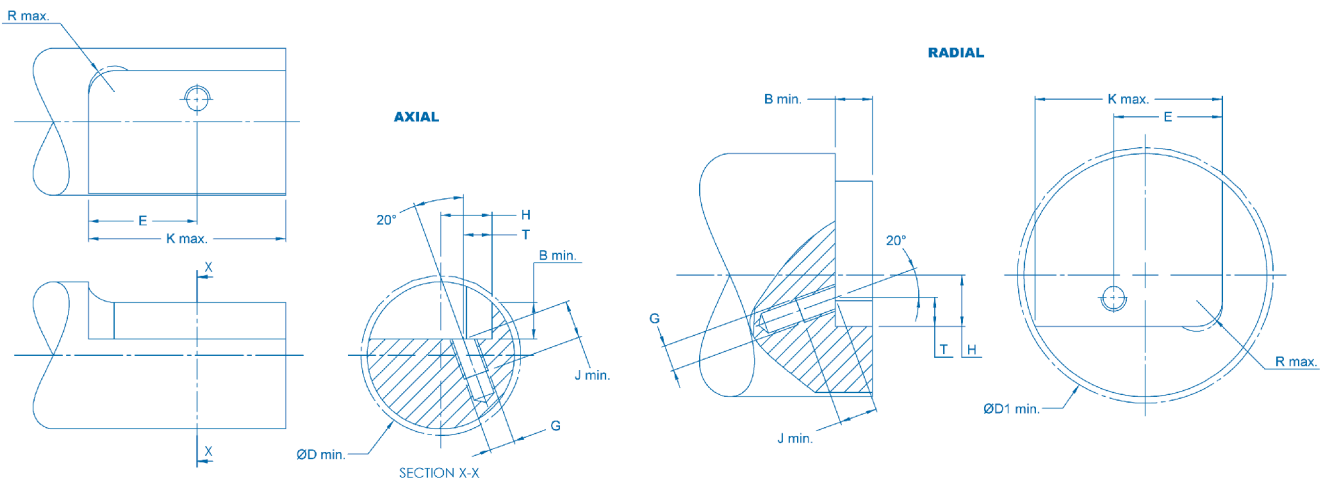

Cartridge	D Min		D1		E		K Max		G	J Min		H		T +0-0.15		B Min		R Min	
	mm	inch	mm	inch	mm	inch	mm	inch		mm	inch	mm	inch	mm	inch	mm	inch	mm	inch
06CA-06X7	15.6	0.614	30.0	1.181	12.0	0.472	23.5	0.925	M3 x 0.5	5.5	0.217	5.5	0.217	2.5	0.098	4.0	0.157	2.5	0.098
06CA-06	20.0 <sup>1</sup>	0.787	31.0	1.220	12.0	0.472	24.0	0.945	M3.5 x 0.5	6.0	0.236	6.0	0.236	3.5	0.138	5.0	0.197	2.5	0.098
08CA	25.0 <sup>2</sup>	0.984	38.0	1.496	17.0	0.669	30.5	1.201	M4 x 0.7	6.5	0.256	8.0	0.315	4.5	0.177	5.8	0.228	4.0	0.157
10CA	40.0	1.575	55.0	2.165	20.0	0.787	48.5	1.909	M6 x 1.0	14.0	0.551	10.0	0.394	5.0	0.197	9.0	0.354	4.0	0.157
12CA	50.0	1.969	75.0	2.953	20.0	0.787	48.5	1.909	M6 x 1.0	14.0	0.551	12.0	0.472	6.0	0.236	13.0	0.512	5.0	0.197
16CA	55.0	2.165	75.0	2.953	25.0	0.984	61.0	2.402	M8 x 1.25	16.0	0.630	15.0	0.591	0(@45°)	0.000	16.5	0.650	6.0	0.236

Note: the following are required for the 16CA-16 cartridge – SHIM RS4129 - SHIM SCREW RSS2471 - SHIM WRENCH R118

<sup>1</sup> D (Min) = 20.0 when H = 6.0 to ISO (but D (Min) = 19.0 is achievable with H = 5.5)

<sup>2</sup> D (Min) = 25.0 when H = 8.0 to ISO (but D (Min) = 20.0 is achievable with H = 7.0)

## ISO and Small Cartridges Mounting Dimensions

Cartridge	Insert Screw	Torx Wrench	Torx Driver	Mounting Screw	Hexagon Wrench (MTG)	Axial Adjustment Screw	Radial Adjustment Screw	Hexagon Wrench (Rada Adjustment)
06CA-06X7	RS2045	R27	R27D	C06X7/5	R28	C06X7/7	C06X7/8	C06X7/9
06CA-06	RS2045	R27	R27D	C06X8/14	R38	C06X7/7	C06X7/8	C06X7/9
08CA-09	RS2263	R37	R37D	C08X10/5	R38	C08X10/7	C08X10/8	C06X7/9
08CA-06	RS2560	R37	R37D	C08X10/5	R38	C08X10/7	C08X10/8	C06X7/9
10CA-09	RS4084	R77	R77D	C10X14/5	R58	C10X14/7	C10X14/8	R28
10CA-11	RS2560	R37	R37D	C10X14/5	R58	C10X14/7	C10X14/8	R28
12CA-12	RS40120	R87	R87D	C12X20/5	R58	C10X14/7	C12X20/8	R38
12CA-16	RS35100	R77	R77D	C12X20/5	R58	C10X14/7	C12X20/8	R38
16CA-16	RS35100	R77	R77D	C16X25/5	C16X25/6	C10X14/7	C16X20/8	R38