



# MBX Fine Boring Units

For fine-finishing  
Extended Adjustment Range

RIGIBORE® Innovation Technology and Quality in Design and Manufacture

### How to contact us:

Telephone a Rigibore representative  
Email Rigibore  
Use our online 'Rapid Quote Request'

YOUR LOCAL RIGIBORE® REPRESENTATIVE IS:

### Global (excl. USA and Mexico)

Rigibore Ltd  
Guildford Road Ind. Est.  
Hayle  
Cornwall TR27 4BA  
United Kingdom

Tel: +44 (0) 1736 755 355  
Fax: +44 (0) 1736 756 100  
Email: info@rigibore.com

[www.rigibore.com](http://www.rigibore.com)

### USA and Mexico

Rigibore Inc  
700 Swan Drive  
Mukwonago  
WI 53149  
USA

Tel: 262 363 3922  
Fax: 262 363 3685  
Email: info@rigiboreinc.com

[www.rigiboreinc.com](http://www.rigiboreinc.com)

# MBX Units

Accuracy through Rigidity  
For fine-finishing

## Key Features

- These units are designed for building into boring tools
- The units are pre-tensioned, eliminating backlash and adjustment is made from the front only
- Each graduation on the adjustment dial is 0.005 / .0002" on radius
- Each vernier graduation on the bush is 0.001mm/.0004" on radius

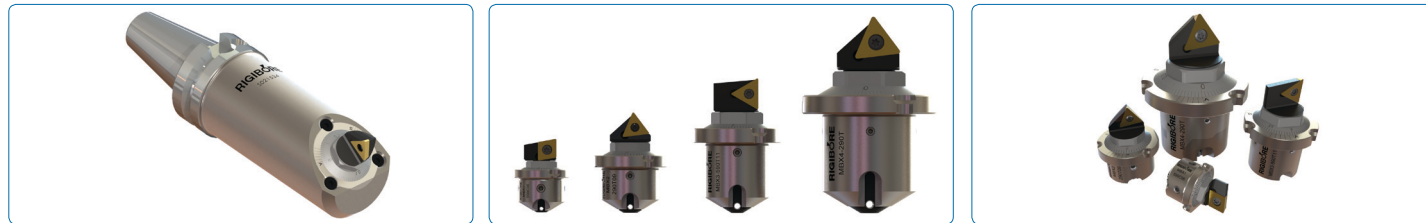

## Rigibore 'MBX' Units Technical Specification

### Rigibore 'MBX' Units Mounting Dimensions

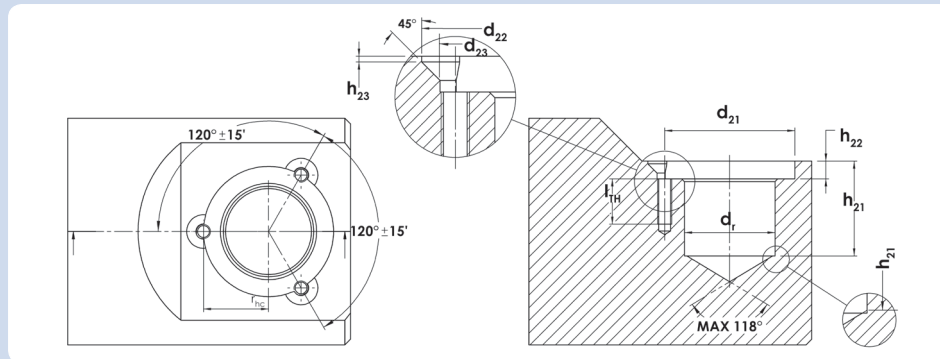

T Style Insert	C Style Insert	d <sub>H7</sub>	d <sub>21</sub> <sup>(1)</sup>	d <sub>22</sub> <sup>(1)</sup>	d <sub>23</sub>	h <sub>21</sub> <sup>(2)</sup>	h <sub>22</sub>	h <sub>23</sub> <sup>(1)</sup>	l <sub>th</sub>	r <sub>hc</sub>	T <sub>h</sub>
	06	16	19	4.6	3.2	11.5	2.8	1.6	9	9.65+/-0.02	M3
06		16	19	4.6	3.2	11.5	2.8	1.6	9	9.65+/-0.02	M3
09		20	25	4.6	3.2	15.5	4	1.6	9	12.5+/-0.05	M3
11		22	30	6.5	4.3	24	5	1.8	13	15.4+/-0.05	M4
16		32	46	11.9	5.4	33	6.3	-	16	23+/-0.05	M5

### Rigibore 'MBX' Units Spares and Accessories

Size	Insert	Insert Screw	Retaining Screw and Wrench Kit	Adjusting Spanner	Torx Wrench	Torx Driver
MBX1	CC..0602	RS2560	BTR001/10/3	R36	R37	R37D
MBX1	TC..06T1	RS2045	BTR001/10/3	R36	R27	R27D
MBX2	TC..0902	RS2263	BTR001/10/3	R46	R37	R37D
MBX3	TC..1102	RS2560	BTR001/7/3	R36	R37	R37D
MBX4	TC..16T3	RS4084	BTR001/8/3	R76	R77	R77D

## Rigibore 'MBX' Units – Straight & Angular

RIGHT HAND VERSION - Shown

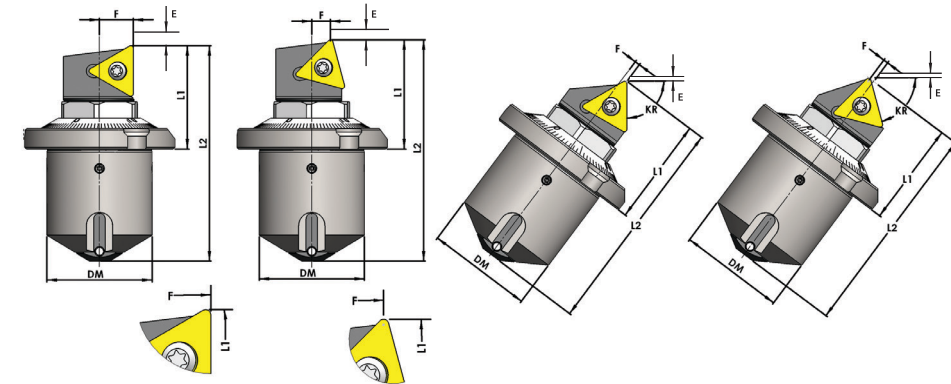

	Entering Angle KR	Insert type	Ordering code	DM	F1 <sup>(1)</sup>	L1 <sup>(2)</sup>	L1 <sup>(3)</sup>	L2	D MIN <sup>(4)</sup>		E MAX
	90°	CC..060204	MBX1-590C06	16	5.10	13.20	13.30	25.10	27.00	0°	2.5
	90°	CC..060204	MBX1-590C06-LH	16	5.10	13.20	13.30	25.10	27.00	0°	2.5
	90°	TC..090204	MBX2-590T09	20	6.30	18.01	18.30	33.40	36.50	0°	3.5
	90°	TC..090204	MBX2-590T09-LH	20	6.30	18.01	18.30	33.40	36.50	0°	3.5
	90°	TC..110204	MBX3-590T11	22	7.20	21.80	22.10	46.00	48.50	0°	6.0
	90°	TC..110204	MBX3-590T11-LH	22	7.20	21.80	22.10	46.00	48.50	0°	6.0
	90°	TC..16T308	MBX4-590T16	32	10.30	31.42	32.00	64.70	68.40	0°	10.0
	90°	TC..16T308	MBX4-590T16-LH	32	10.30	31.42	32.00	64.70	68.40	0°	10.0
		90°	CC..060204	MBX1-290C06	16	0.40	14.08	14.30	26.00	25.30	0°
90°		CC..060204	MBX1-290C06-LH	16	0.40	14.08	14.30	26.00	25.30	0°	2.0
90°		TC..06T102	MBX1-290T06	16	0.25	14.11	14.30	26.00	24.80	0°	2.0
90°		TC..06T102	MBX1-290T06-LH	16	0.25	14.11	14.30	26.00	24.80	0°	2.0
90°		TC..090204	MBX2-290T09	20	1.00	18.70	19.10	34.20	32.50	0°	2.8
90°		TC..090204	MBX2-290T09-LH	20	1.00	18.70	19.10	34.20	32.50	0°	2.8
90°		TC..110204	MBX3-290T11	22	1.20	22.60	23.00	46.80	42.00	0°	4.8
90°		TC..110204	MBX3-290T11-LH	22	1.20	22.60	23.00	46.80	42.00	0°	4.8
90°		TC..16T308	MBX4-290T16	32	1.40	32.51	33.30	66.60	59.40	0°	8.0
90°	TC..16T308	MBX4-290T16-LH	32	1.40	32.51	33.30	66.60	59.40	0°	8.0	

<sup>(1)</sup> 90° approach angular mounted centre of nose radius, 90° approach straight mounting over insert <sup>(2)</sup> Over datum rad for insert size

<sup>(3)</sup> Sharp point

<sup>(4)</sup> Minimum hole diameter calculated on the largest nose radius available